

pascom ceiling swivel arm

Comfort in any position

From any position of the patient's bed, the TV can be operated comfortably and effortlessly according to the patient's needs.

Six hinges ensure that people with limited mobility can easily use the TV set.

The power and data cables are inside. This ensures optimum hygienic conditions. In order to prevent damage to these cables by turning them over, the range of rotation of the spring arm swivel hinge is limited to 320°.

When you care for patients, you can easily bring the swivel arm into the park position, so the TV is not in the way.

Technical specifications:

Construction: 6-hinged swivel arm for ceiling mounting

Maximum Load: designed for loads up to 5 kg (Optional up to 21 kg)

Payload: Adjustable to the weight of the terminal without disassembly

Height stop can be adjusted

Length extension: 750 / 950 mm

Length of the spring arms: 800 mm

Tilting range (adjustable):

top: max. ca. 45°

down: max. ca. 50°

cable completely inside

Terminal adapter: VESA 70x70, rotatable / inclinable, with handle for terminal positioning



The swivel arm serves as a mount for the TV. Patients may not pull themselves up with it.

Terminal guidance: Exactly parallel guidance, the terminal remains straight in every position

Colour:

similar to RAL 9002 (other colours on demand)

Coating: Powder-coated

Weight (incl. terminal adapter): ca. 13.5 kg

pascom ceiling bracket

The ceiling bracket is bolted directly to the concrete ceiling and ensures the stable hold of the ceiling swivel arm. The cabling and electronics is thereby housed either in the subceiling or in the large baldachin (optional).

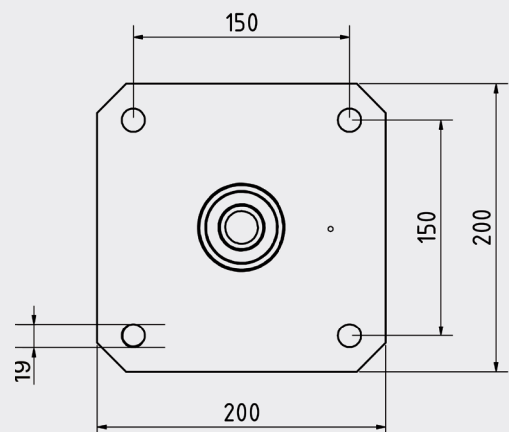
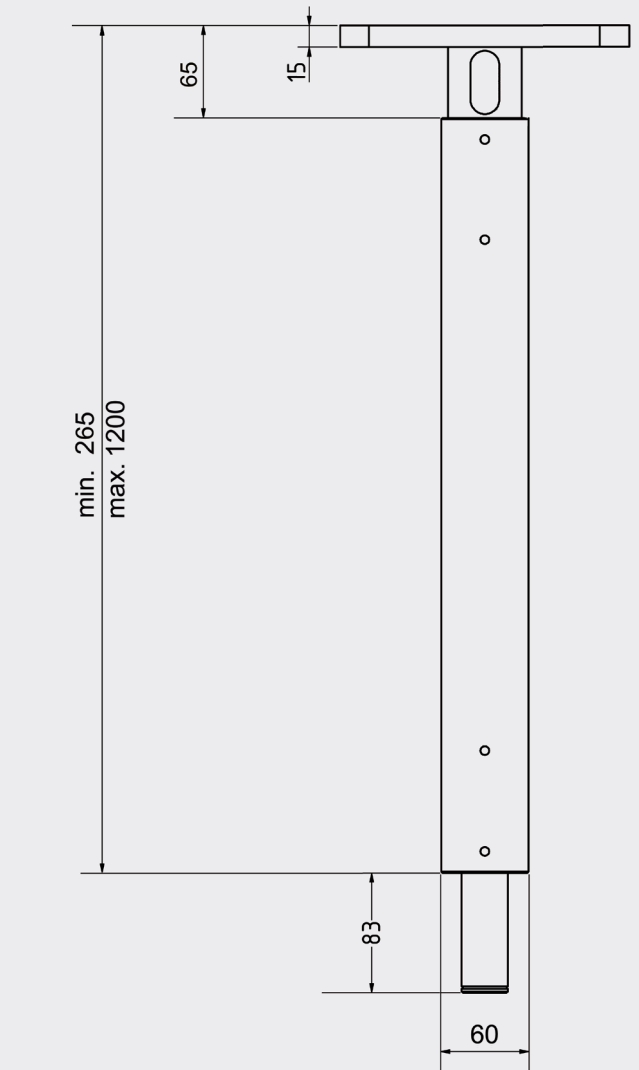
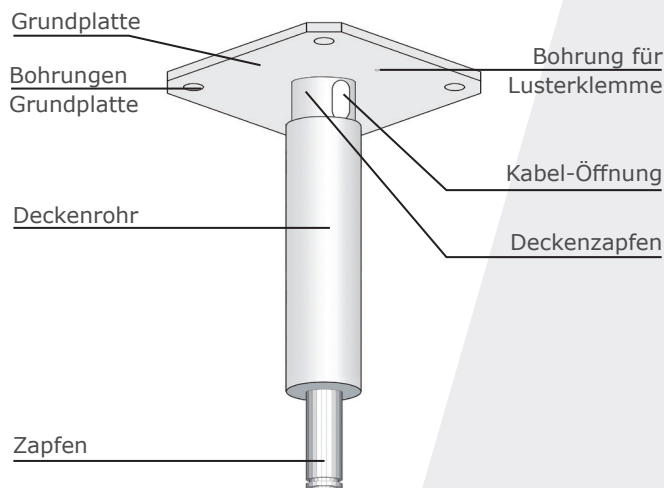

Baldachin for ceiling mount

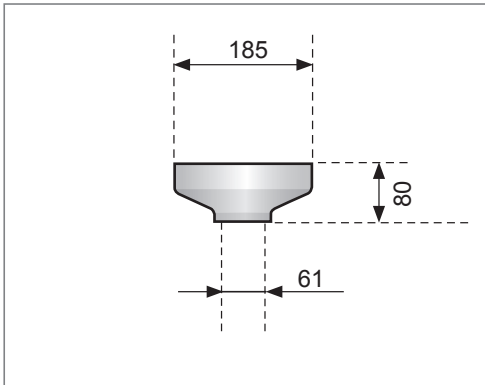

Small baldachin

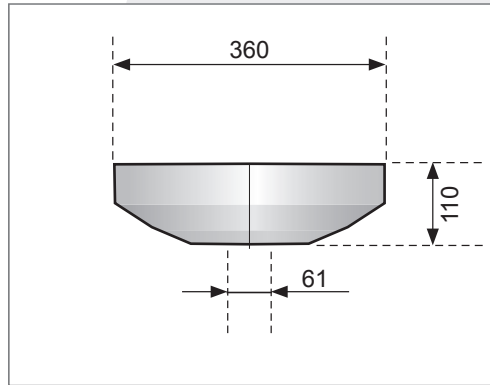

Large baldachin, can be opened

